

Even if you know the exact size, length, material & finish of a bolt you need, you still need to know what style of bolt is right for your application. Bolts come in a large variety of head and thread styles. Use our bolt guide below to help identify the parts you need.

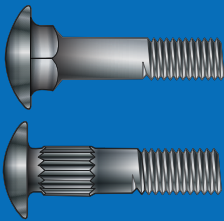

CARRIAGE BOLTS



Standard Carriage Bolts (Square Neck)

Standard carriage bolts come in square neck style, with some parts available in a short neck option. Featuring a round head with a square neck under the head, along with machine screw threads, the square neck is designed to keep the bolt from turning as a nut is tightened. The short neck variety is used in sheet metal where a standard sized neck would create an obstruction.

Material / Finish Options:

Steel / Zinc
Steel / Hot Dip Galvanized
Steel / Black Oxide
Grade 5 / Zinc
Grade 8 / Zinc Yellow
18-8 Stainless Steel
(Short neck in steel / zinc only)

Ribbed Neck Carriage Bolts

Same head shape as a standard carriage bolt, but the square shape under the head is replaced with vertical ribs slightly wider than the diameter of the bolt. The ribs help prevent the bolt from turning as a nut is tightened or removed.

Material / Finish Options:

Steel / Zinc
Grade 5 / Zinc
18-8 Stainless Steel

Bolt Types *cont.*

DOWEL SCREWS



A two sided fastener with wood screw type threads and points at both ends. Inserted into a pre-drilled hole, they are commonly used for fastening two pieces of wood together in a permanent position, relative to one another. Frequently used in the furniture industry.

Offered in Steel / Zinc.

ELEVATOR BOLTS

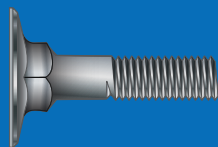

Bolt with a wide, countersunk flat head, a shallow conical bearing surface, an integrally-formed square neck under the head, and a unified thread pitch. Similar to carriage bolts, except that the top of the head is flat, rather than the bottom of the head. Provides a low profile fastening solution. Popular use is in conveyor systems, such as elevators.

Offered in Steel / Zinc.

HANGER BOLTS

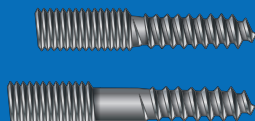

Hanger bolts are available in full thread and plain center options. They are threaded at both ends, with one side having wood screw type threads, and the other having machine screw threads. Designed for the wood screw side to be inserted into a pre-drilled pilot hole, the machine threads becomes a post with which to attach materials. Used for suspending electrical wiring and sheet metal, as well as commonly used in the furniture industry.

Material / Finish Options:

Steel / Zinc
18-8 Stainless Steel

HEX CAP SCREWS

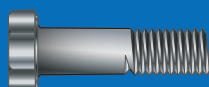

Most common type of hex head bolt. Our hex cap screws start at 1/4" diameters and go up to 1 1/2" diameters, with lengths up to 16". Hex cap screws are the most common type of bolt and generally come partially threaded (as opposed to hex tap bolts). Our selection includes metric sizes as well.

Material / Finish Options:

Grade 2 / Zinc
Grade 2 / Black Oxide
Grade 5 / Plain
Grade 5 / Zinc
Grade 8 / Plain
Grade 8 / Zinc Yellow
18-8 Stainless Steel
316 Stainless Steel
Silicon Bronze

Metric Material / Finish Options:

Grade 8.8 / Zinc
Grade 10.9 Plain



Bolt Types *cont.*

HEX FLANGE / FRAME BOLTS

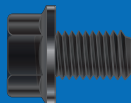

Commonly used in the automotive industry, flange / frame bolts consist of a one-piece indented hex washer head bolt with a flat, flanged bearing surface. The flange eliminates washers and can help compensate for misaligned holes.

Material / Finish Options:

Grade 8 / Black Phos
18-8 Stainless Steel

Metric Material / Finish Options:

Grade 8.8 / Plain
Grade 8.8 / Zinc
Grade 10.9 / Black Phos

HEX MACHINE BOLTS

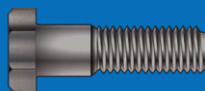

Unlike hex cap screws, hex machine bolts don't feature a washer face on the bearing surface (bottom of the head). The galvanized finish provides better corrosion resistance than a standard zinc coating, and requires matching nuts to have tapped oversize holes.

Offered in Steel with a Hot Dip Galvanized finish.

HEX TAP BOLTS



Always fully threaded, hex tap bolts are used in threaded holes or combined with a hex nut to create a strong fastening system. To be used in drilled and tapped holes which are threaded full length. Used instead of a stud and a nut.

Material / Finish Options:

Steel / Zinc
Grade 5 / Zinc
Grade 8 / Plain
Grade 8 / Zinc Yellow
18-8 Stainless Steel

LAG BOLTS

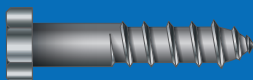

Also called lag screws, or hex lag screws, lag bolts, feature a hex head, spaced threads and a gimlet point. Lag screws are generally used in pre-drilled holes in wood, or with lag screw shields in a variety of materials. Also available in high-profile, hex-flange, and acoustical eye styles.

Material / Finish Options:

Steel / Plain
Steel / Zinc
Steel / Hot Dip Galvanized
Steel / Black Oxide
18-8 Stainless Steel



Bolt Types *cont.*

PLOW BOLTS

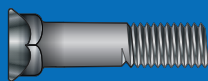

Featuring a countersunk, flat head; a square neck; and machine / cap screw threading, plow bolts are used in heavy duty equipment that requires a smooth head surface.

Material / Finish Options:

- Grade 5 / Plain
- Grade 5 / Zinc
- Grade 10 / Plain

SLOTTED FLAT HEAD CAP SCREWS



Slotted flat head cap screws are commonly used in close tolerance machinery. The countersunk head allows for superior head clearance.

Offered in Steel / Zinc.

SQUARE HEAD MACHINE BOLTS

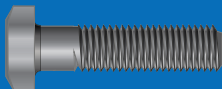

Combined with square nuts or hex nuts, square head machine bolts offer greater bearing surface for wrenching. Our selection includes Battery Bolts.

Offered in Steel with a plain finish.

STEP BOLTS

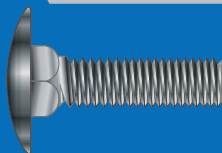

Featuring a wide, low-profile, slightly rounded head and a square neck, step bolts are used when a large bearing surface needs to be combined with a low profile head. Similar to a carriage bolt in bearing surface and square-neck design, but with a wider, lower-profile, round head. Preferred for use where wood is bolted down as decking--the larger diameter head of the step bolt will not pull through the softwood.

Offered in Steel / Zinc.

STRUCTURAL BOLTS



Often used on structural steel joints in heavy construction, structural bolts are also heat treated. The bearing surface is flat and washer faced. Commonly used in structural steel joints in heavy construction.

Material / Finish Options:

- A325 (Medium Carbon Steel / Plain)
- A325 (Medium Carbon Steel / Hot Dip Galvanized)

THREADED ROD

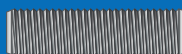

Externally threaded and headless, we offer threaded rod in diameters from 1/2" - 1", and in lengths up to 7".

Offered in Grade B7 Steel with a Plain Finish.

FASTENER BUYING MADE SIMPLE

The Fastener Superstore is your one stop shop for screws, nuts, bolts, washers, rivets, standoffs and more! We have everything you need right here.

- ✓ 34,000+ Distinct Parts
- ✓ All Pricing Online
- ✓ No Registration Required
- ✓ Same Day Shipping on Most Orders
- ✓ Order online, via phone, email or fax
- ✓ Extended Customer Service Hours (7am-7pm CT)
- ✓ Quotes Available for Larger Quantities

